

**SEARS** Operator's Manual

# CRAFTSMAN<sup>®</sup>

1.4 cu. in./21cc 2-Cycle / .065 In. Line  
16 Inch Cutting Path

## GASOLINE WEEDWACKER<sup>®</sup>

Model No.  
**358.798520**

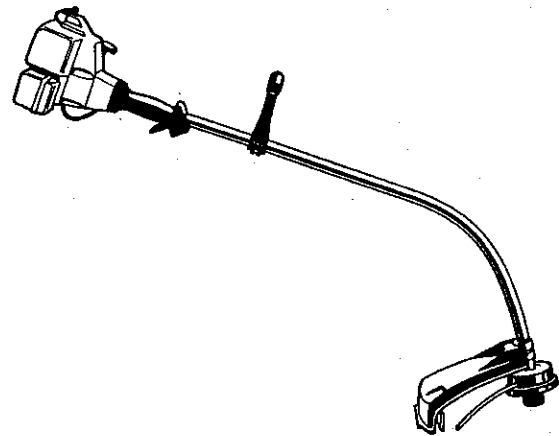

**WARNING:**

Read and follow all Safety Rules and Operating Instructions before first use of this product.



For answers to your questions about this product:  
Call 7 am–7 pm, Mon–Sat; Sun, 10 am–7 pm

**1-800-235-5878**

Sears, Roebuck and Co., Hoffman Estates, IL 60179 USA

530-084025 3/13/96

SAFETY

ASSEMBLY

OPERATION

MAINTENANCE

PARTS LIST

ESPAÑOL

## TABLE OF CONTENTS

Warranty Statement	2	Service & Adjustments	9
Safety Rules	2	Storage	11
Assembly	4	Troubleshooting Chart	12
Operation	5	Spanish	16
Maintenance	8	Parts and Ordering	Back

## WARRANTY STATEMENT

### FULL ONE YEAR WARRANTY ON CRAFTSMAN GAS POWERED WEEDWACKER® LINE TRIMMER.

For one year from the date of purchase, when this Craftsman Gas Powered Weedwacker® Line Trimmer is maintained, lubricated, and tuned up according to the operating and maintenance instructions in the operator's manual, Sears will repair, free of charge, any defect in material or workmanship.

This warranty excludes nylon line, spark plug, and air filter, which are expendable parts and become worn during normal use.

If this Weedwacker® Line Trimmer is used for commercial purposes, this warranty applies for only 90 days from the date of purchase. If this Weedwacker® Line Trimmer is used for rental purposes, this warranty applies for only 30 days from the date of purchase. This warranty applies only while this product is in use in the United States.

WARRANTY SERVICE IS AVAILABLE BY RETURNING THE WEEDWACKER® LINE TRIMMER TO THE NEAREST SEARS SERVICE CENTER IN THE UNITED STATES.

This warranty gives you specific legal rights, and you may also have other rights which vary from state to state.

Sears, Roebuck and Co. Dept. D/817WA Hoffman Estates, IL 60179

## SAFETY RULES

**WARNING:** When using gardening appliances, basic safety precautions must always be followed to reduce the risk of fire and serious injury. Read and follow all instructions.

*This power unit can be dangerous!* Operator is responsible for following instructions and warnings on unit and in manual. Read entire Operator's Manual before using unit! Be thoroughly familiar with the controls and the proper use of the unit. Restrict the use of this unit to persons who have read, understand, and will follow the instructions and warnings on the unit and in the manual. Never allow children to operate this unit.



Safety information on the unit

**DANGER:** Never use blades or flailing devices. This unit is designed for line trimmer use only. Use of any other accessories or attachments will increase the risk of injury.



**WARNING:** Trimmer line throws objects violently. You and others can be blinded/injured. Wear eye and leg

- If situations occur which are not covered in this manual, use care and good judgement. If you need assistance, contact Sears Service or call 1-800-235-5878.

#### **OPERATOR SAFETY**

- Always wear safety eye protection.
- Always wear long pants, long sleeves, boots, and gloves. Wearing safety leg guards is recommended. Do not go barefoot or wear sandals. Stay clear of spinning line.
- Secure hair above shoulder length. Secure or remove loose clothing or clothing with loosely hanging ties, straps, tassels, etc. They can be caught in moving parts.
- Do not operate when you are tired, ill, or under the influence of alcohol, drugs, or medication.
- Wear hearing protection if you use unit for more than 1-1/2 hours per day.
- Never start or run inside a closed room or building. Breathing exhaust fumes can kill.
- Keep handles free of oil and fuel.

#### **UNIT / MAINTENANCE SAFETY**

- Disconnect the spark plug before performing maintenance except carburetor adjustments.
- Look for and replace damaged or loose parts before each use. Look for and repair fuel leaks before use. Keep in good working condition.
- Replace trimmer head parts that are chipped, cracked, broken, or damaged in any other way before using the unit.
- Make sure unit is assembled correctly as shown in this manual.
- Make carburetor adjustments with lower end supported to prevent line from contacting any object.
- Keep others away when making carburetor adjustments.
- Use only recommended Craftsman accessories and replacement parts.

#### **FUEL SAFETY**

- Mix and pour fuel outdoors.
- Keep away from sparks or flames.
- Use a container approved for fuel.
- Do not smoke or allow smoking near fuel or the unit.
- Wipe up all fuel spills.

- Move at least 10 feet (3 meters) away from fueling site before starting engine.
- Stop engine and allow to cool before removing fuel cap.

#### **CUTTING SAFETY**

- Use only for trimming, mowing, edging, and sweeping. Do not use for pruning or hedge trimming.
- Inspect the area before each use. Remove objects (rocks, broken glass, nails, wire, etc.) which can be thrown by or become entangled in line. Hard objects can damage the trimmer head and be thrown causing serious injury.
- Keep firm footing and balance. Do not overreach.
- Keep all parts of your body away from muffler and spinning line. Keep engine below waist level. A hot muffler can cause serious burns.
- Cutting on left side of the shield will throw debris away from the operator.

#### **TRANSPORTING AND STORAGE**

- Allow engine to cool; secure unit before storing or transporting in vehicle.
- Empty the fuel tank before storing or transporting the unit. Use up fuel left in the carburetor by starting the engine and letting it run until it stops.
- Store unit and fuel in area where fuel vapors cannot reach sparks or open flames from water heaters, electric motors or switches, furnaces, etc.
- Store unit so line limiter cannot accidentally cause injury. The unit can be hung by the tube.
- Store unit out of reach of children.
- If situations occur which are not covered in this manual, use care and good judgment. If you need assistance, call 1-800-235-5878.

**SPECIAL NOTICE:** This unit is not equipped with a temperature limiting muffler and spark arresting screen which meets the requirements of California Codes 4442 and 4443. All U.S. forest land and the states of California, Idaho, Maine, Minnesota, New Jersey, Oregon, and Washington require by law that many internal combustion engines be equipped with a spark arrester screen. If you operate in a locale where such regulations exist, you are

legally responsible for installing and maintaining the operating condition of these parts. Failure to do so is a violation of the law. Refer to the MAINTENANCE section in this manual.

**SPECIAL NOTICE:** Exposure to vibrations through prolonged use of gasoline powered hand tools could cause blood vessel or nerve damage in the fingers, hands, and joints of people prone to circulation disorders or abnormal swellings. Prolonged use in cold weather has been linked to blood

vessel damage in otherwise healthy people. If symptoms occur such as numbness, pain, loss of strength, change in skin color or texture, or loss of feeling in the fingers, hands, or joints, discontinue the use of this tool and seek medical attention. An anti-vibration system does not guarantee the avoidance of these problems. Users who operate power tools on a continual and regular basis must monitor closely their physical condition and the condition of this tool.

## ASSEMBLY

### CARTON CONTENTS

Check carton contents against the following list.

#### Model 358.798520

- Trimmer
- Shield
- Container of Oil

Examine parts for damage. Do not use damaged parts.

**NOTE:** If you need assistance or find parts missing or damaged, call 1-800-235-5878.

It is normal for the fuel filter to rattle in the empty fuel tank.

Finding fuel or oil residue on muffler is normal due to carburetor adjustments and testing done by the manufacturer.

### ASSEMBLY

**WARNING:** If received assembled, repeat all steps to ensure your unit is properly assembled and all fasteners are secure.

### ADJUSTING THE HANDLE

**WARNING:** When adjusting the handle, be sure it remains between the trigger and the safety label.

- Loosen wing nut or knob on handle.
- Rotate the handle on the tube to an upright position; retighten wing nut.

### ATTACHING SHIELD

**WARNING:** The shield must be properly installed. The shield provides partial protection from the risk of thrown objects to the operator and others and is equipped with a line limiter which cuts excess line to the proper length. The line limiter (on underside of shield) is sharp and can cut you. For proper orientation, see illustration in Operation section.

- Remove wing nut from shield.
- Insert bracket into slot as shown.
- Pivot shield until bolt passes through hole in bracket.
- Securely tighten wing nut onto bolt.

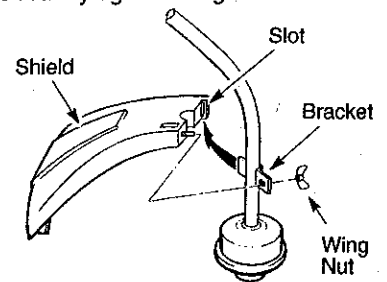

## OPERATION

### KNOW YOUR TRIMMER

READ THIS OPERATOR'S MANUAL AND SAFETY RULES BEFORE OPERATING YOUR UNIT. Compare the illustrations with your unit to familiarize yourself with the location of the various controls and adjustments. Save this manual for future reference.

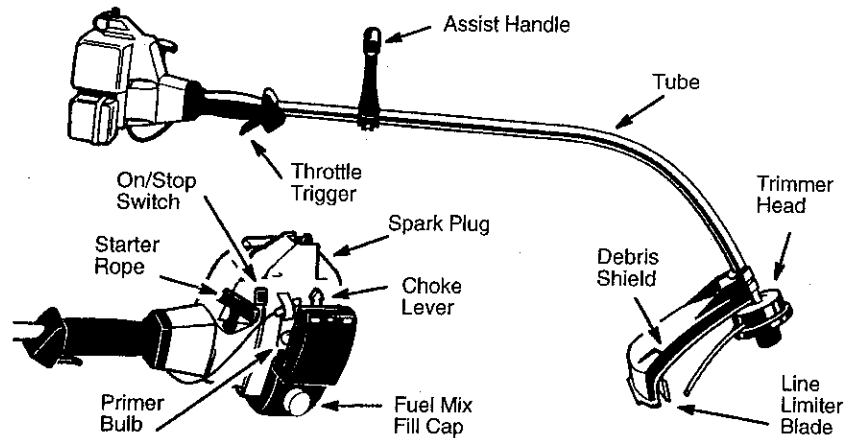

#### ON/STOP SWITCH

The On/Stop switch is used to stop the engine. Press and hold the switch to stop the unit.

#### PRIMER BULB

The primer bulb removes air from the fuel lines and fills them with fuel. This allows you to start the engine with fewer pulls on the starter rope. Activate the primer bulb by pressing it and allowing it to return to its original form.

#### CHOKE

The choke helps to supply fuel to the carburetor during starting. This allows you to start a cold engine. Activate the choke by moving the choke lever to the Full position. After the engine has started, move the choke to the Off position.

#### BEFORE STARTING ENGINE

**WARNING:** Be sure to read the fuel information in the safety rules before you begin. If you do not understand the safety rules, do not attempt to fuel your unit. Call 1-800-235-5878.

#### FUELING ENGINE

This engine is certified to operate on unleaded gasoline. Before operation, gasoline must be mixed with a good quality 2-cycle air-cooled engine oil. We recommend Craftsman brand oil. Mix gasoline and oil at a ratio of 40:1 (A 40:1 ratio is obtained by mixing 3.2 ounces of oil with 1 gallon of unleaded gasoline). **DO NOT USE** automotive oil or boat oil. These oils will cause engine damage. When mixing fuel, follow instructions printed on container. Once oil is added to gasoline, shake container momentarily to assure that the fuel is thoroughly mixed. Always read and follow the safety rules relating to fuel before fueling your unit.

#### IMPORTANT

Experience indicates that alcohol blended fuels (called gasohol or using ethanol or methanol) can attract moisture which leads to separation and formation of acids during storage. Acidic gas can damage the fuel system of an engine while in storage. To avoid engine problems, empty the fuel system before storage for 30 days or longer. Drain the gas tank, start the engine and let it run until the fuel lines

and carburetor are empty. Use fresh fuel next season.

Never use engine or carburetor cleaner products in the fuel tank or permanent damage may occur.

See the STORAGE section for additional information.

#### STOPPING YOUR ENGINE

- Press and hold the On/Stop switch in the STOP position.
- If engine does not stop, move choke to the Full Choke position.

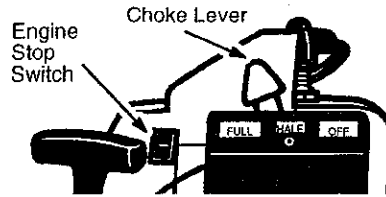

#### STARTING YOUR ENGINE COLD ENGINE OR WARM ENGINE AFTER RUNNING OUT OF FUEL

**WARNING:** The trimmer head will turn while starting the engine. Avoid any contact with the muffler. A hot muffler can cause serious burns.

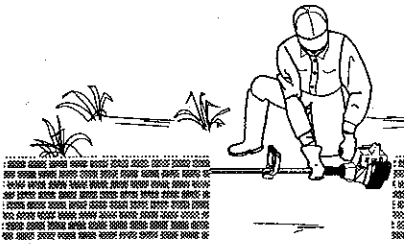

- Rest engine and shield on ground, supporting trimmer head off ground.
- Move the choke lever to the Full Choke position.
- Slowly press the primer bulb 6 times.
- Squeeze and hold the throttle trigger. Keep throttle trigger fully squeezed until the engine runs smoothly.

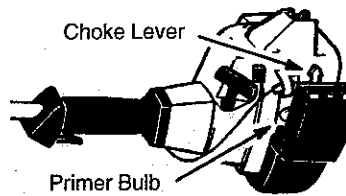

- Pull starter rope sharply 5 times.

**NOTE:** If the engine sounds as if it is trying to start before the 5<sup>th</sup> pull, go to the next step.

- Move the choke lever to the Half Choke position.
- Pull starter rope sharply until engine runs, but no more than 6 pulls.

**NOTE:** If the engine has not started after 6 pulls (at half choke), check to make sure the choke lever is in the proper position. Then, move the choke lever to the Full Choke position and press the primer bulb 6 times; squeeze and hold the throttle trigger and pull the starter rope 2 more times. Move the choke lever to Half Choke and pull the starter rope until the engine runs, but no more than 6 more pulls. If the engine still has not started, it is probably flooded. Proceed to "Starting a Flooded Engine."

- Allow the engine to run 10 seconds, then move the choke lever to Off Choke. Allow the unit to run for 30 more seconds at Off Choke before releasing the throttle trigger.

**NOTE:** If engine dies with the choke lever at the Off Choke position, move the choke lever to Half Choke and pull the rope until engine runs.

#### STARTING A WARM ENGINE

- Move the choke lever to the Half Choke position.
- Squeeze and hold the throttle trigger. Keep throttle trigger fully squeezed until the engine runs smoothly.
- Pull starter rope sharply until engine runs, but no more than 5 pulls.
- Allow engine to run 15 seconds, then move the choke lever to Off Choke.

**NOTE:** If engine has not started, pull starter rope 5 more pulls. If engine still does not run, it is probably flooded.

#### DIFFICULT STARTING OR STARTING A FLOODED ENGINE

Flooded engines can be started by placing the choke lever in the Off Choke position; then, pull the rope to clear the engine of excess fuel. This could require pulling the starter handle many times depending on how badly the unit is flooded.

If the unit still doesn't start, refer to TROUBLESHOOTING chart or call 1-800-235-5878.

### OPERATING INSTRUCTIONS

Bring the engine to cutting speed before entering the material to be cut.

Do not run the engine at a higher speed than necessary. The cutting line will cut efficiently when the engine is run at less than full throttle. At lower speeds, there is less engine noise and vibration. The cutting line will last longer and will be less likely to "weld" onto the spool.

If the trimmer head does not turn when the engine is in operation, make sure the drive shaft housing is properly seated in engine shroud.

Always release the throttle trigger and allow the engine to return to idle speed when not cutting.

To stop engine:

- Release the throttle trigger.
- Push and hold down the momentary switch until the engine has stopped completely.

### TRIMMER LINE ADVANCE

The trimmer line will advance approximately 2 in. (5 cm) each time the bottom of the trimmer head is tapped on the ground with the engine running at full throttle.

The most efficient line length is the maximum length allowed by the line limiter.

Always keep the shield in place when the tool is being operated.

To Advance Line:

- Operate the engine at full throttle.
- Hold the trimmer head parallel to and above the grassy area.
- Tap the bottom of the trimmer head lightly on the ground one time. Approximately 2 in. (5 cm) of line will be advanced with each tap.

To advance line, tap bottom of trimmer head on ground one time.

Line limiter cuts line to proper length.

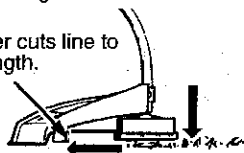

Always tap the trimmer head on a grassy area. Tapping on surfaces such as concrete or asphalt can cause excessive wear to the trimmer head.

If the line is worn down to 2 in. (5 cm) or less, more than one tap will be required to obtain the most efficient line length.

**WARNING:** Use only .065" (1.6 mm) diameter line. Other sizes of line will not advance properly and can cause serious injury. Do not use other materials such as wire, string, rope, etc. Wire can break off during cutting and become a dangerous missile that can cause serious injury.

### CUTTING METHODS

**WARNING:** Use minimum speed and do not crowd the line when cutting around hard objects (rock, gravel, fence posts, etc.), which can damage the trimmer head, become entangled in the line, or be thrown causing a serious hazard.

- The tip of the line does the cutting. You will achieve the best performance and minimum line wear by not crowding the line into the cutting area. The right and wrong ways are shown below.

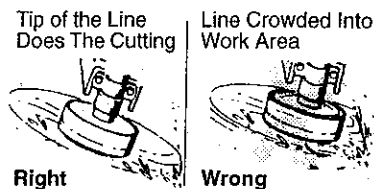

Right

Wrong

- The line will easily remove grass and weeds from around walls, fences, trees and flower beds, but it also can cut the tender bark of trees or shrubs and scar fences. To help avoid damage especially to delicate vegetation or trees with tender bark, shorten line to 4-5 in. (10-13 cm) and use at less than full throttle.
- For trimming or scalping, use less than full throttle to increase line life and decrease head wear, especially:
  - During light duty cutting.
  - Near objects around which the line can wrap such as small posts, trees or fence wire.
- For mowing or sweeping, use full throttle for a good clean job.

**WARNING:** Always wear eye protection. Never lean over the trimmer head. Rocks or debris can ricochet or be thrown into eyes and face and cause blindness or other serious injury.

**TRIMMING** – Hold the bottom of the trimmer head about 3 in. (8 cm) above the ground and at an angle. Allow only the tip of the line to make contact. Do not force trimmer line into work area.

Trimming

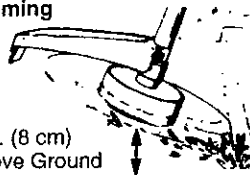

3 in. (8 cm)  
Above Ground

**SCALPING** – The scalping technique removes unwanted vegetation. Hold the bottom of the trimmer head about 3 in. (8 cm) above the ground and at an angle. Allow the tip of the line to strike the ground around trees, posts, monuments, etc. This technique increases line wear.

Scalping

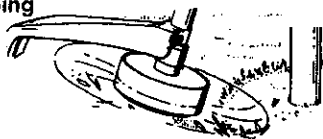

**MOWING** – Your trimmer is ideal for mowing in places conventional lawn mowers cannot reach. In the mowing position, keep the line parallel to the ground. Avoid pressing the head into the ground as this can scalp the ground and damage the tool.

Mowing

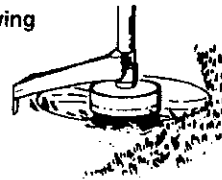

**SWEEPING** – The fanning action of the rotating line can be used for a quick and easy clean up. Keep the line parallel to and above the surfaces being swept and move the tool from side to side.

Sweeping

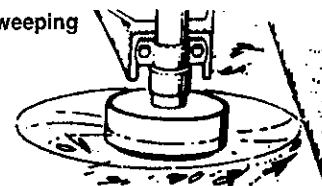

## MAINTENANCE

### MAINTENANCE SCHEDULE

CARE & MAINTENANCE TASK	WHEN TO PERFORM
Check for Loose fasteners and parts	Before each use
Check for damaged or worn parts	Before each use
Clean unit and labels	After each use
Clean air filter	Every 5 hours of operation
Inspect and clean spark arrestor	Every 25 hours of operation
Replace spark plug	Yearly

### GENERAL RECOMMENDATIONS

The warranty on this unit does not cover items that have been subjected to operator abuse or negligence. To receive full value from the warranty, the operator must maintain unit as instructed in this manual. Various adjustments will need to be made periodically to properly maintain your unit.

### CHECK FOR LOOSE FASTENERS AND PARTS

- Spark Plug Boot
- Air Filter
- Housing Screws
- Assist Handle Screws
- Debris Shield



### CHECK FOR DAMAGED OR WORN PARTS

Refer replacement of damaged/worn parts to your Sears Service Center.

- On/Stop Switch – Ensure On/Stop switch functions properly by moving the switch to the "Stop" position. Make sure engine stops; then restart engine and continue.
- Fuel Tank – Discontinue use of unit if fuel tank shows signs of damage or leaks.
- Debris Shield – Discontinue use of unit if debris shield is damaged.

### CLEAN UNIT & LABELS

- Clean the unit using a damp cloth with a mild detergent.
- Wipe off unit with a clean dry cloth.

### CLEAN AIR FILTER

Do not clean filter in gasoline or other flammable solvent to avoid creating a fire hazard or producing harmful evaporative emissions.

#### Cleaning the air filter:

A dirty air filter decreases engine performance and increases fuel consumption and harmful emissions. Always clean after every 5 hours of operation.

- Clean the cover and the area around it to keep dirt and debris from falling into the carburetor chamber when the cover is removed.
- Remove parts as illustrated.

- Wash the filter in soap and water.
- Allow filter to dry.
- Replace parts.

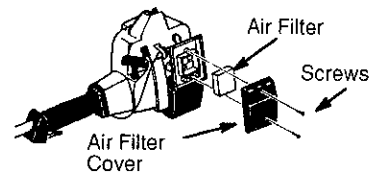

### INSPECT AND CLEAN SPARK ARRESTOR (if equipped)

As the unit is used, carbon deposits build up on the muffler and spark arrestor screen, and must be removed to avoid creating a fire hazard or affecting engine performance.

Remove the spark arrestor screen from the muffler and clean. Replace spark arrestor screen if breaks occur.

### REPLACE SPARK PLUG

Replace the spark plug each year to ensure the engine starts easier and runs better. Set spark plug gap at .025 in. Ignition timing is fixed and nonadjustable.

- Twist, then pull off spark plug boot.
- Remove spark plug from cylinder and discard.
- Replace with Champion RCJ-8Y spark plug and tighten with a 3/4 in. socket wrench (10-12 ft.-lbs).
- Reinstall the spark plug boot.

## SERVICE AND ADJUSTMENTS

### OPERATING POSITION

ALWAYS WEAR:

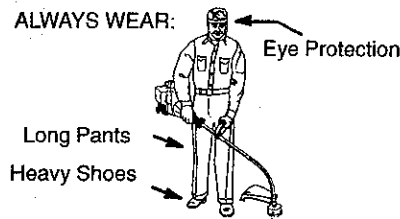

Cut from your right to your left.

### ADVANCING THE CUTTING LINE

Advance line by tapping bottom of cutting head lightly on the ground while engine is running at full speed. A metal blade attached to the shield will cut the line to the proper length.

### REPLACING THE LINE

- Remove the spool by firmly pulling on the tap button.
- Clean entire surface of hub and spool.
- Replace with a pre-wound spool, or cut a length of 20 feet of .065" (1.6 mm) diameter Craftsman® brand line. Never use wire, rope, string, etc., which can break off and become a dangerous missile.
- Insert one end of the line about 1/2 inch (1 cm) into the small hole inside the spool.
- Wind the line evenly and tightly onto the spool. Wind in the direction of the arrow found on the spool.

- Push the line into the notch, leaving 3 to 5 inches (7 – 12 cm) unwound.
- Insert the line into the exit hole in the hub as shown in the illustration.
- Align the notch with the line exit hole.
- Push the spool into the hub until it snaps into place.
- Pull the line extending outside the hub to release it from the notch.

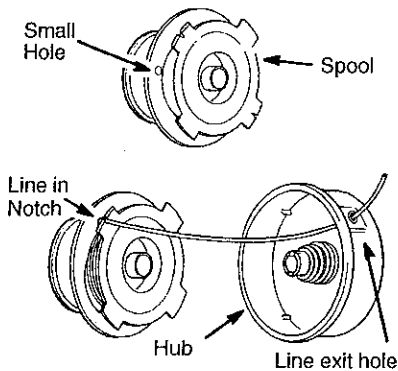

### CARBURETOR ADJUSTMENT

**WARNING:** The trimmer head will be spinning during most of this procedure. Wear your protective equipment and observe all safety precautions. After making mixture adjustments, recheck idle speed.

Carburetor adjustment is critical and if done improperly can permanently damage the engine as well as the carburetor. If you require further assistance or are unsure about performing this procedure, call our customer assistance help line at 1-800-235-5878. Old fuel, a dirty air filter, a dirty fuel filter, or flooding may give the impression of an improperly adjusted carburetor. Check these conditions before adjusting the carburetor.

The carburetor has been carefully set at the factory. Adjustments may be necessary if you notice any of the following conditions:

- Engine will not idle. See "Idle Speed" under adjusting procedure.
- Engine dies or hesitates instead of accelerating. See "Acceleration Check" under adjusting procedure.
- Loss of cutting power. See "Mixture Adjustment" under adjusting procedure.

There are two adjustment screws on the carburetor. They are located in the area just above the primer bulb.

### CARBURETOR PRESETS

When making carburetor preset adjustments, do not force plastic limiter caps beyond stops or damage will occur.

If carburetor presets are not needed, proceed to "Adjusting Procedure, Idle Speed."

To adjust presets:

- Turn mixture screw counterclockwise until it stops.
- Turn the idle speed screw clockwise until it stops. Now turn counterclockwise 4-1/2 turns.
- Start motor, cut grass for 3 minutes, and proceed to the adjustment section. If engine does not start, refer to troubleshooting chart or call 1-800-235-5878.
- If engine performance is acceptable at the preset positions, no further adjustment is necessary.

### ADJUSTING PROCEDURE

#### Idle Speed

Allow engine to idle. Adjust speed until engine runs without stalling.

- Turn clockwise to increase engine speed if engine stalls or dies.
- Turn counterclockwise to decrease speed.

No further adjustments are necessary if performance is satisfactory.

#### Mixture Adjustment "H"

DO NOT operate engine at full throttle for prolonged periods while making adjustments. Damage to the engine can occur. Extend line to the length allowed by the line limiter and cut some grass. Based on performance while cutting, turn the mixture adjustment in 1/16-turn increments as follows:

- Clockwise until the engine has good power while cutting with no hesitation.

Do not adjust by sound or speed, but judge by how well the engine performs while cutting.

- Counterclockwise if the engine has speed but dies or lacks power while cutting.

After completing adjustments, check for acceleration. Reset if necessary.

### Acceleration Check

If engine dies or hesitates instead of accelerating, turn mixture adjustment counterclockwise until you have smooth acceleration. Recheck and adjust as necessary for acceptable performance.

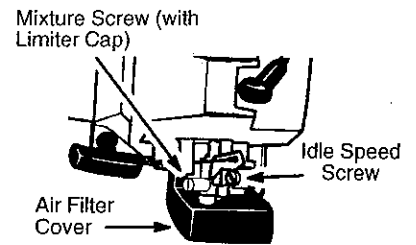

## STORAGE

Prepare unit for storage at end of season or if it will not be used for 30 days or more.

### WARNING:

- Allow engine to cool, and secure the unit before storing or transporting.
- Store unit and fuel in a well ventilated area where fuel vapors cannot reach sparks or open flames from water heaters, electric motors or switches, furnaces, etc.
- Store unit with all guards in place. Position unit so that any sharp object cannot accidentally cause injury.
- Store unit and fuel well out of the reach of children.

### EXTERNAL SURFACES

If your unit is to be stored for a period of time, clean it thoroughly before storage. Store in a clean dry area.

- Lightly oil external metal surfaces.

### FUEL SYSTEM

Under Fueling Engine in the Operating Section of this manual, see message labeled **IMPORTANT** regarding the use of gasohol in your engine.

Fuel stabilizer is an acceptable alternative in minimizing the formation of fuel gum deposits during storage. Add

stabilizer to the gasoline in the fuel tank or fuel storage container. Follow the mix instructions found on stabilizer container. Run engine at least 5 minutes after adding stabilizer.

CRAFTSMAN 40:1, 2-cycle engine oil (air cooled) is already blended with fuel stabilizer. If you do not use this Sears oil, you can add a fuel stabilizer to your fuel tank.

### INTERNAL ENGINE

- Remove spark plug and pour 1 teaspoon of 40:1, 2-cycle engine oil (air cooled) through the spark plug opening. Slowly pull the starter rope 8 to 10 times to distribute oil.
- Replace spark plug with new one of recommended type and heat range.
- Clean air filter.
- Check entire unit for loose screws, nuts, and bolts. Replace any damaged, broken, or worn parts.
- At the beginning of the next season, use only fresh fuel having the proper gasoline to oil ratio.

### OTHER

- Do not store gasoline from one season to another.
- Replace your gasoline can if it starts to rust.

## TROUBLESHOOTING CHART

TROUBLE	CAUSE	REMEDY
Engine will not start.	<ul style="list-style-type: none"> <li>• Engine flooded.</li> <li>• Fuel tank empty.</li> <li>• Spark plug not firing.</li> <li>• Fuel not reaching carburetor.</li> <li>• Compression low.</li> </ul>	<ul style="list-style-type: none"> <li>• See "Starting Instructions."</li> <li>• Fill tank with correct fuel mixture.</li> <li>• Install new spark plug.</li> <li>• Check for dirty fuel filter; clean.</li> <li>• Check for kinked or split fuel line; repair or replace.</li> <li>• Contact Sears Service.</li> </ul>
Engine will not idle properly.	<ul style="list-style-type: none"> <li>• Idle speed set too low.</li> <li>• Idle speed set too high.</li> <li>• Carburetor requires adjustment.</li> <li>• Crankshaft seals worn.</li> <li>• Compression low.</li> </ul>	<ul style="list-style-type: none"> <li>• Adjust idle speed screw clockwise to increase speed.</li> <li>• Adjust idle speed screw counter-clockwise to reduce speed.</li> <li>• See "Carburetor Adjustments."</li> <li>• Contact Sears Service.</li> <li>• Contact Sears Service.</li> </ul>
Engine will not accelerate, lacks power, or dies under a load.	<ul style="list-style-type: none"> <li>• Air filter dirty.</li> <li>• Spark plug fouled.</li> <li>• Carburetor requires adjustment.</li> <li>• Carbon build up.</li> <li>• Compression low.</li> </ul>	<ul style="list-style-type: none"> <li>• Clean or replace air filter.</li> <li>• Clean or replace spark plug and re-gap.</li> <li>• See "Carburetor Adjustments."</li> <li>• Contact Sears Service.</li> <li>• Contact Sears Service.</li> </ul>
Engine smokes excessively.	<ul style="list-style-type: none"> <li>• Choke partially on.</li> <li>• Fuel mixture incorrect.</li> <li>• Air filter dirty.</li> <li>• Carburetor requires adjustment.</li> </ul>	<ul style="list-style-type: none"> <li>• Adjust choke.</li> <li>• Empty fuel tank and refill with correct fuel mixture.</li> <li>• Clean or replace air filter.</li> <li>• See "Carburetor Adjustments."</li> </ul>
Engine runs hot.	<ul style="list-style-type: none"> <li>• Fuel mixture incorrect.</li> <li>• Spark plug incorrect.</li> <li>• Carburetor requires adjustment</li> <li>• Carbon build up.</li> </ul>	<ul style="list-style-type: none"> <li>• See "Fueling Your Unit."</li> <li>• Replace with correct spark plug.</li> <li>• See "Carburetor Adjustments."</li> <li>• Contact Sears Service.</li> </ul>

# REPAIR PARTS

**WARNING**

All repairs, adjustments and maintenance not described in the Operator's Manual must be performed by qualified service personnel.

SEARS MODEL 358.798520

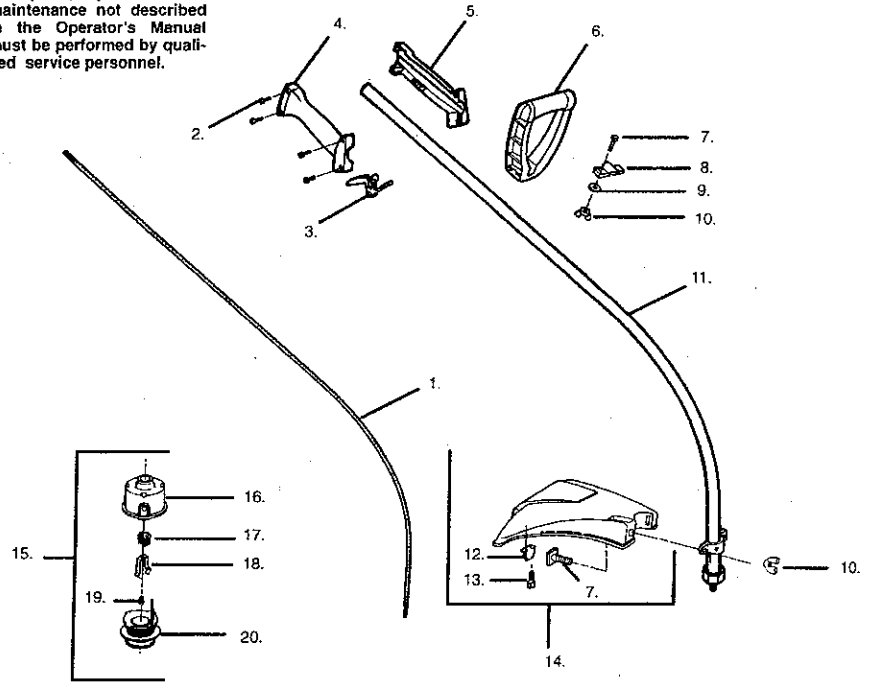

Ref.	Part No.	Description	Ref.	Part No.	Description
1.	530-402473	Drive Shaft	16.	530-069690	Hub Ass'y
2.	530-015880	Screw-Throttle Hsg.	17.	530-401464	Spring
3.	530-049107	Trigger	18.	530-401466	Clip-Retainer-Head
4.	530-038581	Throttle Hsg. (Right)	19.	530-401467	Screw w/ Washer-Head
5.	530-038580	Throttle Hsg. (Left)	20.	71-85822	Spool w/Line
6.	530-038708	Assist Handle			
7.	530-015820	Bolt-Handle/Shield			
8.	530-094742	Clamp-Handle			
9.	530-092062	Washer-Handle			
10.	530-016152	Wingnut-Handle/Shield			
11.	530-069691	Drive Shaft Hsg. Ass'y	Not Shown		
12.	530-095238	Line Limiter			
13.	530-015814	Screw-Line Limiter			
14.	530-069686	Shield Kit Ass'y. (Incl. 7, 10, 12 & 13)		530-084025	Operator Manual
15.	71-85839	Cutting Head Ass'y. (Incl. 16-20)		530-047467	Shaft Warning Decal
				530-049125	Shroud Decal
				530-049365	Starting Instruction Decal

# REPAIR PARTS

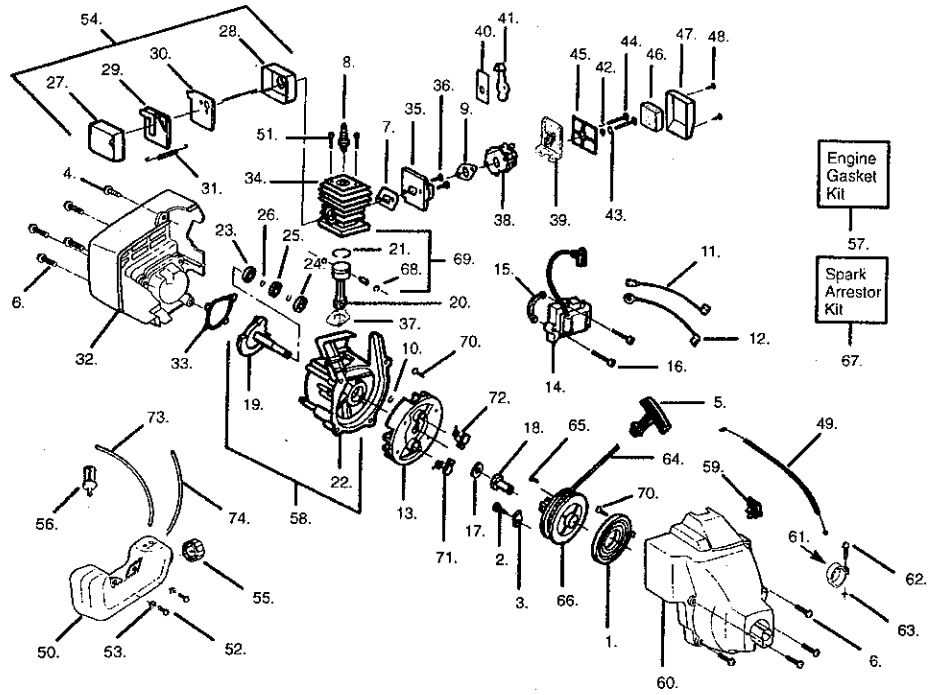

Ref.	Part No.	Description	Ref.	Part No.	Description	Ref.	Part No.	Description
1.	530-029395	Starter Spring	28.	530-036577	Muffler Cover	54.	530-069389	Muffler Kit
2.	530-015775	Screw-Pulley	29.	530-038602	Muffler Baffle-Exit	55.	530-014347	Fuel Cap Assy.
3.	530-027523	Retainer-Pulley	30.	530-036579	Muffler Baffle-First	56.	530-014362	Fuel Pickup Assy
4.	530-015934	Screw-Shrd/Fan Hsg.	31.	530-029930	Muffler Spring	57.	530-069616	Engine Gasket Kit (Incl. 7,9,33, 37)
5.	530-027569	Starter Handle	32.	530-047991	Rear Shroud	58.	530-014729	C'case/C'shaft Assy. (Incl. 10,19,22-26)
6.	530-015810	Screw	33.	530-019181	Gasket-C'case	59.	530-038114	On/Off Switch
7.	530-019233	Gasket-Cylinder/Carb.	34.	530-069619	Cylinder Kit	60.	530-069766	Fan Hsg. Assy.
8.	Champion	Spark Plug (RCJ-8Y)	35.	530-069769	Carb. Adaptor Kit	61.	530-016126	Clamp-Nose Cone
9.	530-019194	Gasket-Carb.	36.	530-016014	Screw-Carb Adptr.	62.	530-015875	Screw-Nose Cone
10.	530-015945	Retainer Ring-C'case	37.	530-019223	Gasket-Cylinder	63.	530-016124	Nut-Nose Cone
11.	530-014663	Lead Wire	38.	530-069642	Carb. Kit-WA 223 (Incl. Limiter Cap &Primer Bulb)	64.	530-069232	Rope Kit
12.	530-014662	Ground Wire	39.	530-038582	Air Box	65.	530-016080	Screw
13.	530-039149	Flywheel	40.	530-038747	Choke Plate	66.	530-069400	Starter Pulley Kit (Incl. 65)
14.	530-039163	Ignition Module	41.	530-049118	Choke Shutter	67.	530-069380	Spark Arrestor Kit
15.	530-036145	Spacer-Ignit. Module	42.	530-015254	Wave Washer	68.	530-015162	Piston Pin Retainer
16.	530-015954	Screw-Ignit. Module	43.	530-015852	Choke Spacer	69.	530-069621	Piston Kit (Incl. 21,68 & Pin)
17.	530-015828	Washer-Thrust	44.	530-015887	Screw-Carburetor	70.	530-015882	Screw-Flywheel
18.	530-038604	Drive Coupling	45.	530-036569	Filter Plate	71.	530-029939	Starter Dog
19.	530-014532	Crankshaft Ass'y.	46.	530-036575	Air Filter Foam	72.	530-047570	Spring Starter Dog
20.	530-069615	Connecting Rod Assy.	47.	530-036568	Air Filter Cover	73.	530-069247	Fuel Line-Carb./Tank
21.	530-036404	Piston Ring	48.	530-015966	Screw-Air Box	74.	530-069216	Fuel Line-Prim./Tank
22.	530-014861	Crankcase Assy. (Incl. 23-26)	49.	530-036744	Throttle Cable Assy			
23.	530-032125	Inner Bearing	50.	530-049296	Fuel Tank Ass'y.			
24.	530-032124	Outer Bearing	51.	530-015953	Screw-Cylinder			
25.	530-019179	C'case Seal	52.	530-015814	Screw-Fuel Tank			
26.	530-015941	Ret. Ring/C'shaft	53.	530-016131	Washer-Fuel Tank			
27.	530-036578	Muffler Body						

# REPAIR PARTS

Carburetor Assembly Kit Number #530-069642 - WA-223

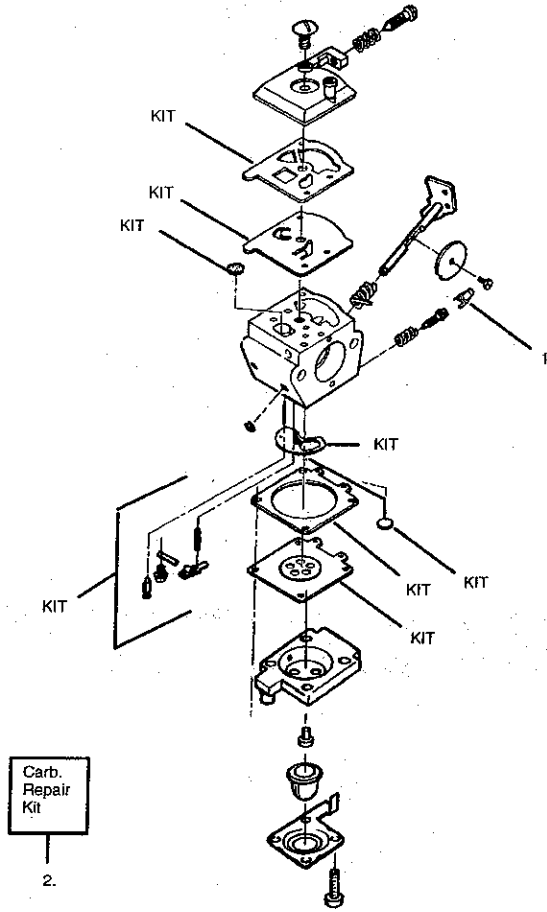

Ref.	Part No.	Description
1.	530-038404	Limiter Cap
2.	530-069668	Carburetor Repair Kit (KIT= CONTENTS)