







600 Watts  
Models: JE510  
JE520

# ***Sub-Compact Microwave Oven***

## *Owner's Manual*

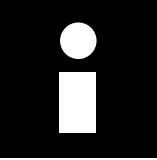
---

	<b><i>Important Safety Information</i></b> <span style="float: right;"><b>2</b></span> <i>Precautions to Avoid Possible Exposure to Excessive Microwave Energy .....2</i> <i>Special Notes About Microwaving .....6</i>
	<b><i>Operating Instructions</i></b> <span style="float: right;"><b>11</b></span> <i>Features of Your Microwave .....11</i> <i>The Controls on Your Microwave .....12</i> <i>Time Cooking .....15</i> <i>Other Features .....20</i>
	<b><i>Helpful Information</i></b> <span style="float: right;"><b>21</b></span> <i>Care and Cleaning .....22</i>
	<b><i>If Something Goes Wrong</i></b> <span style="float: right;"><b>24</b></span> <i>Before You Call For Service .....24</i> <i>GE Service Numbers .....26</i> <i>Warranty .....Back Cover</i>

***GE Answer Center®***  
***800.626.2000***

*GE Appliances*

---



## ***Important Safety Information***

*Read all safety information before using*

### ***For Your Safety***

#### **! PRECAUTIONS TO AVOID POSSIBLE EXPOSURE TO EXCESSIVE MICROWAVE ENERGY**

For your safety the information in this manual must be followed to minimize the risk of fire or explosion or to prevent property damage, personal injury or loss of life.

***Do Not Attempt*** to operate this oven with the door open since open-door operation can result in harmful exposure to microwave energy. It is important not to defeat or tamper with the safety interlocks.

***Do Not Place*** any object between the oven front face and the door or allow soil or cleaner residue to accumulate on sealing surfaces.

***Do Not Operate*** the oven if it is damaged. It is particularly important that the oven door close properly and that there is no damage to the:

- 1** door (bent)
- 2** hinges and latches (broken or loosened)
- 3** door seals and sealing surfaces.

***The Oven Should Not*** be adjusted or repaired by anyone except properly qualified service personnel.

## Welcome

Welcome to the GE family. We're proud of our quality products and we believe in dependable service. You'll see it in this easy-to-use manual and you'll hear it in the friendly voices of our customer service department.

Best of all, you'll experience these values each time you use your microwave. That's important, because your new microwave will be part of your family for a long time.

## Start Here!

*Before  
using  
your  
microwave  
oven*

**Staple your receipt to the inside back cover of this manual.**

**Write down the model and serial numbers here.** They are on a label inside the oven.

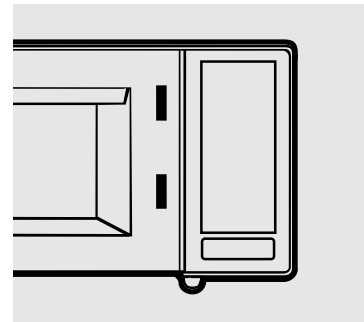

---

**Model number**

---

**Serial number**

---

**Date of purchase**

## Need Help?

*Help us  
help you*

**800.626.2000**

Before you call for service, there are a few things you can do to help us serve you better.

**Read this manual.** It contains instructions to help you use and maintain your microwave properly.

**If you received a damaged oven...** Immediately contact the dealer (or builder) that sold you the oven.

**Save time and money.** Check the section titled "If Something Goes Wrong" before calling. This section was designed to solve common problems you might encounter.

If you do need service, you can relax knowing help is only a phone call away. A list of toll-free customer service numbers is included in the back of this book. Or call the GE Answer Center® at 800.626.2000, 24 hours a day, 7 days a week.



## ***Important Safety Information***

*Read all safety information before using*



### **Warning**

***To reduce the risk of fire, electric shock, injury to persons, or exposure to excessive microwave energy when using your appliance, follow basic precautions, including the following sections.***

### **Safety Precautions**

***This microwave oven is not approved or tested for marine use.***

- Read and follow the specific “Precautions to Avoid Possible Exposure to Excessive Microwave Energy.”
- This appliance must be grounded. Connect only to properly grounded outlet. See Grounding Instructions section.
- Do not mount this appliance over a sink.
- Install or locate this appliance only in accordance with the provided Installation Instructions.
- Be certain to place the front surface of the door three inches or more back from the countertop edge to avoid accidental tipping of the appliance in normal usage.
- Do not mount the microwave oven over or near any portion of a heating or cooking appliance.
- Do not store anything directly on top of the microwave oven surface when the microwave oven is in operation.
- Do not cover or block any openings on the appliance.
- Do not operate any heating or cooking appliance beneath this microwave.
- Do not operate this appliance if it has a damaged power cord or plug, if it is not working properly, or if it has been damaged or dropped.
- Use this appliance only for its intended use as described in this guide. Do not use corrosive chemicals or vapors in this appliance. This microwave oven is specifically designed to heat or cook food, and is not intended for laboratory or industrial use.
- Do not store this appliance outdoors. Do not use this product near water—for example, in a wet basement, near a swimming pool or near a sink.
- Keep power cord away from heated surfaces.
- Do not immerse power cord or plug in water.
- Do not let power cord hang over edge of table or counter.



- To reduce the risk of fire in the oven cavity:
  - Do not overcook food. Carefully attend appliance if paper, plastic or other combustible materials are placed inside the oven while cooking.
  - Remove wire twist ties and metal handles from paper or plastic containers before placing them in the oven.
  - Do not use the oven for storage purposes. Do not leave paper products, cooking utensils or food in the oven when not in use.
  - If materials inside oven should ignite, keep the oven door closed, turn the oven off and disconnect the power cord, or shut off power at the fuse or circuit breaker panel. If the door is opened, the fire may spread.
- See door surface cleaning instructions in the Care and Cleaning section(s) of this guide.
- This appliance should be serviced only by qualified service personnel. Contact nearest authorized service facility for examination, repair or adjustment.
- As with any appliance, close supervision is necessary when used by children.

*SAVE THESE INSTRUCTIONS*



## Important Safety Information

### *Special Notes About Microwaving*

#### **Arcing**

***If you see arcing, press the CLEAR/OFF pad and correct the problem.***

Arcing is the microwave term for sparks in the oven. Arcing is caused by:

- Metal or foil touching the side of the oven.
- Foil not molded to food (upturned edges act like antennas).
- Metal, such as twist ties, poultry pins, or gold-rimmed dishes, in the microwave.
- Recycled paper towels containing small metal pieces being used in the microwave.

#### **Foods**

- Do not pop popcorn in your microwave oven unless in a special microwave popcorn accessory or unless you use popcorn labeled for use in microwave ovens.
- Some products such as whole eggs and sealed containers—for example, closed jars—will explode and should not be heated in this microwave oven. Such use of the microwave oven could result in injury.
- Do not boil eggs in a microwave oven. Pressure will build up inside egg yolk and will cause it to burst, possibly resulting in injury.
- Operating the microwave with no food inside for more than a minute or two may cause damage to the oven and could start a fire. It increases the heat around the magnetron and can shorten the life of the oven.
- Foods with unbroken outer “skin” such as potatoes, hot dogs, sausages, tomatoes, apples, chicken livers and other giblets, and egg yolks should be pierced to allow steam to escape during cooking.
- Avoid heating baby food in glass jars, even with the lid off. Make sure all infant food is thoroughly cooked. Stir food to distribute the heat evenly. Be careful to prevent scalding when warming formula or breast milk. The container may feel cooler than the milk really is. Always test the milk before feeding the baby.



### **SAFETY FACT**

#### **SUPERHEATED WATER**

***Microwaved water and other liquids do not always bubble when they reach the boiling point. They can actually get superheated and not bubble at all.***

***Superheated liquid will bubble up out of the cup when it is moved or when something like a spoon or tea bag is put into it.***

***To prevent this from happening and causing injury, do not heat any liquid for more than 2 minutes per cup. After heating, let the cup stand in the microwave for 30 seconds before moving it or putting anything into it.***

- Spontaneous boiling—Under certain special circumstances, liquids may start to boil during or shortly after removal from the microwave oven. To prevent burns from splashing liquid, we recommend the following: before removing the container from the oven, allow the container to stand in the oven for 30 to 40 seconds after the oven has shut off. Do not boil liquids in narrow-necked containers such as soft drink bottles, wine flasks and especially narrow-necked coffee cups. Even if the container is opened, excessive steam can build up and cause it to burst or overflow.
- Don't defrost frozen beverages in narrow-necked bottles (especially carbonated beverages). Even if the container is opened, pressure can build up. This can cause the container to burst, possibly resulting in injury.
- Hot foods and steam can cause burns. Be careful when opening any containers of hot food, including popcorn bags, cooking pouches and boxes. To prevent possible injury, direct steam away from hands and face.
- Do not overcook potatoes. They could dehydrate and catch fire, causing damage to your oven.
- When cooking pork, follow the directions exactly and always cook the meat to an internal temperature of at least 170°F. This assures that, in the remote possibility that trichina may be present in the meat, it will be killed and meat will be safe to eat.



## Important Safety Information

### Special Notes About Microwaving

#### Microwave-Safe Cookware

**If you use a meat thermometer while cooking, make sure it is safe for use in microwave ovens.**



How to Test for a Microwave-Safe Dish

Make sure all cookware used in your microwave oven is suitable for microwaving. Most glass casseroles, cooking dishes, measuring cups, custard cups, pottery or china dinnerware which does not have metallic trim or glaze with a metallic sheen can be used. Some cookware is labeled “suitable for microwaving.”

- If you are not sure if a dish is microwave-safe, use this test: Place in the oven both the dish you are testing and a glass measuring cup filled with 1 cup of water—set the measuring cup either in or next to the dish. Microwave 1 minute at high. If the dish heats, it should not be used for microwaving. If the dish remains cool and only the water in the cup heats, then the dish is microwave-safe.
- Do not use recycled paper products. Recycled paper towels, napkins and waxed paper can contain metal flecks which may cause arcing or ignite. Paper products containing nylon or nylon filaments should be avoided, as they may also ignite.
- Some styrofoam trays (like those that meat is packaged on) have a thin strip of metal embedded in the bottom. When microwaved, the metal can burn the floor of the oven or ignite a paper towel.
- Do not use the microwave to dry newspapers.
- Not all plastic wrap is suitable for use in microwave ovens. Check the package for proper use.
- Paper towels, waxed paper and plastic wrap can be used to cover dishes in order to retain moisture and prevent spattering. Be sure to vent plastic wrap so steam can escape.
- Cookware may become hot because of heat transferred from the heated food. Pot holders may be needed to handle the cookware.
- “Boilable” cooking pouches and tightly closed plastic bags should be slit, pierced or vented as directed by package. If they are not, plastic could burst during or immediately after cooking, possibly resulting in injury. Also, plastic storage containers should be at least partially uncovered because they form a tight seal. When cooking with containers tightly covered with plastic wrap, remove covering carefully and direct steam away from hands and face.
- Use foil only as directed in this guide. TV dinners may be microwaved in foil trays less than 3/4” high; remove the top foil cover and return the tray to the box. When using foil in the microwave oven, keep the foil at least 1 inch away from the sides of the oven.





- **Plastic cookware**—Plastic cookware designed for microwave cooking is very useful, but should be used carefully. Even microwave-safe plastic may not be as tolerant of overcooking conditions as are glass or ceramic materials and may soften or char if subjected to short periods of overcooking. In longer exposures to overcooking, the food and cookware could ignite.

Follow these guidelines:

- 1** Use microwave-safe plastics only and use them in strict compliance with the cookware manufacturer's recommendations.
- 2** Do not microwave empty containers.
- 3** Do not permit children to use plastic cookware without complete supervision.

## Grounding Instructions

### Grounding Instructions

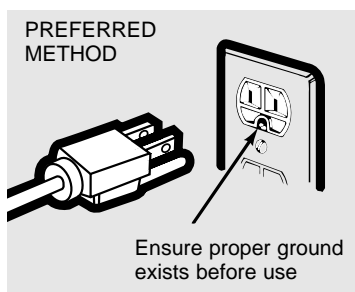

**⚠ WARNING—Improper use of the grounding plug can result in a risk of electric shock.**

This appliance must be grounded. In the event of an electrical short circuit, grounding reduces the risk of electric shock by providing an escape wire for the electric current. This appliance is equipped with a power cord having a grounding wire with a grounding plug. The plug must be plugged into an outlet that is properly installed and grounded.

Consult a qualified electrician or service technician if the grounding instructions are not completely understood, or if doubt exists as to whether the appliance is properly grounded.

If the outlet is a standard 2-prong wall outlet, it is your personal responsibility and obligation to have it replaced with a properly grounded 3-prong wall outlet.

Do not under any circumstances cut or remove the third (ground) prong from the power cord.



## Important Safety Information

### Grounding Instructions

#### Use of Adapter Plugs

(Adapter plugs not permitted in Canada)

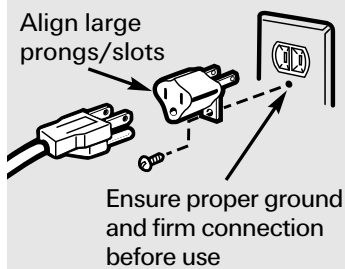

TEMPORARY METHOD

#### **Usage situations where appliance's power cord will be disconnected infrequently.**

Because of potential safety hazards under certain conditions, **we strongly recommend against the use of an adapter plug.** However, if you still elect to use an adapter, where local codes permit, a TEMPORARY CONNECTION may be made to a properly grounded two-prong wall receptacle by the use of a UL listed adapter which is available at most local hardware stores.

The larger slot in the adapter must be aligned with the larger slot in the wall receptacle to provide proper polarity in the connection of the power cord.

**CAUTION:** Attaching the adapter ground terminal to the wall receptacle cover screw does not ground the appliance unless the cover screw is metal, and not insulated, and the wall receptacle is grounded through the house wiring.

You should have the circuit checked by a qualified electrician to make sure the receptacle is properly grounded.

When disconnecting the power cord from the adapter, always hold the adapter with one hand. If this is not done, the adapter ground terminal is very likely to break with repeated use. Should this happen, **DO NOT USE** the appliance until a proper ground has again been established.

#### **Usage situations where appliance's power cord will be disconnected frequently.**

**Do not use an adapter plug** in these situations because frequent disconnection of the power cord places undue strain on the adapter and leads to eventual failure of the adapter ground terminal. You should have the two-prong wall receptacle replaced with a three-prong (grounding) receptacle by a qualified electrician before using the appliance.

#### Use of Extension Cords

A short power-supply cord is provided to reduce the risks resulting from becoming entangled in or tripping over a longer cord.

Extension cords may be used if you are careful in using them.

If an extension cord is used—

- 1** The marked electrical rating of the extension cord should be at least as great as the electrical rating of the appliance;

- 2** The extension cord must be a grounding-type 3-wire cord and it must be plugged into a 3-slot outlet;

- 3** The extension cord should be arranged so that it will not drape over the counter top or tabletop where it can be pulled on by children or tripped over unintentionally.

If you use an extension cord, the interior light may flicker and the blower sound may vary when the microwave oven is on. Cooking times may be longer, too.

# Operating Instructions

## Features of Your Microwave

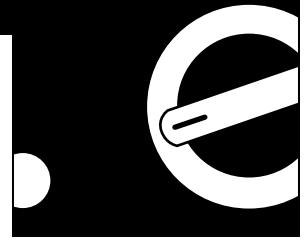

### Features

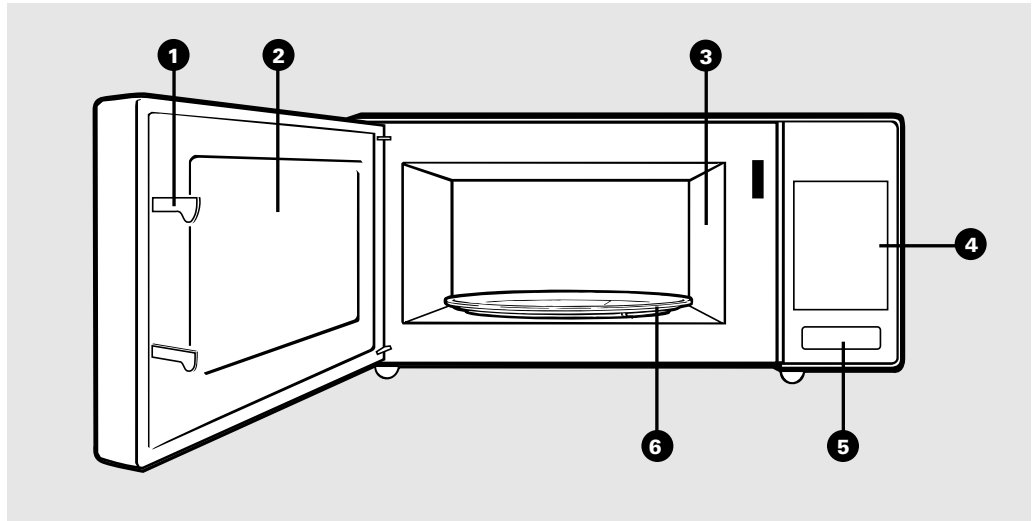

**Wattage:  
600 Watts**

**Optional Accessory  
(Available at extra cost  
from your GE supplier):  
4-A019-3 Hanging Kit  
allows this oven to be  
mounted under a cabinet.**

- 1 Door Latches.**
- 2 Window with Metal Shield.** Screen allows cooking to be viewed while keeping microwaves confined in the oven.
- 3 Waveguide Cover (on some models).** Protects the microwave energy distributing system. Do not remove this cover. You will damage the oven.
- 4 Control Panel Display (panel layout will vary by model).**
- 5 Door Open Bar.** Press to open door. Door must be securely latched for oven to operate.
- 6 Removable Turntable.** Turntable and support **must** be in place when using the oven. The turntable may be removed for cleaning.

**NOTE:** Rating plate, oven vent(s) and the oven interior light (on some models) are located on the inside walls of the microwave oven.



## **Quick Start** *(Features and appearance vary by model)*

*The  
controls  
on your  
microwave  
oven*

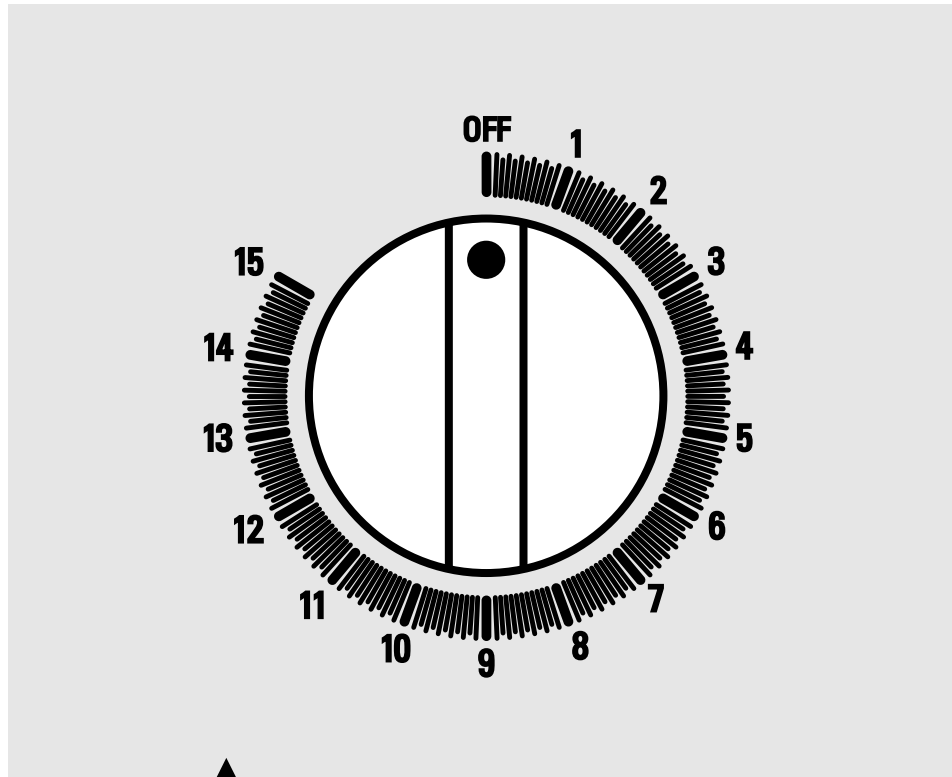

### **1** *Timer*

Allows you to cook by time for up to 15 minutes.



## GUIDES IN BOOK

- Cooking
- Defrosting
- Heating and Reheating

**POWER LEVEL / TIME COOK**

**DEFROST**



## **2** *Time Features*

Allows you to cook by time.

<i>Press</i>	<i>Enter</i>
<b>POWER LEVEL/TIME COOK</b> (press one to ten times to choose power level)	<b>Amount of cooking time.</b>
<b>DEFROST</b>	<b>Amount of defrosting time.</b>



# Operating Instructions

## Changing Power Levels

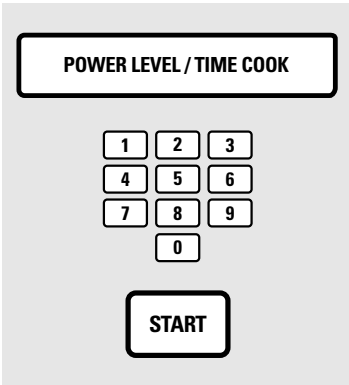

### How to Change the Power Level

The power level may be changed before setting the cooking time.

- 1 Press POWER LEVEL/TIME COOK one to ten times to choose a power level other than Hi.
- 2 Enter cooking time.
- 3 Press START.

Variable power levels add flexibility to your microwave cooking. The power levels on your microwave oven can be compared to the surface units on a range. Hi or full power is the fastest way to cook and gives you 100% power. Each power level gives you microwave energy a certain percent of the time. Power Level 70 is microwave energy 70% of the time. Power Level 30 is energy 30% of the time.

Power Level Hi will cook faster but food may need additional attention such as frequent stirring, rotating or turning over. Most of your cooking will be done on Hi. A lower setting will cook more evenly and with less attention given to stirring or rotating the food. Some foods may have better flavor, texture or appearance if one of the lower settings is used. You may wish to use a lower power level when cooking foods that have a tendency to boil over, such as scalloped potatoes.

Rest periods (when the microwave energy cycles off) give time for the food to “equalize” or transfer heat to the inside of the food. An example of this is shown with Power Level 30—the defrost cycle. If microwave energy did not cycle off, the outside of the food would cook before the inside was defrosted.

Here are some examples of uses for various power levels:

Power Level	Best Uses
<b>Hi</b>	Fish, bacon, vegetables, boiling liquids.
<b>Med-High 70</b>	Gentle cooking of meat and poultry; baking casseroles and reheating.
<b>Medium 50</b>	Slow cooking and tenderizing such as stews and less tender cuts of meat.
<b>Low 30</b>	Defrosting without cooking; simmering; delicate sauces.
<b>Warm 10</b>	Keeping food warm without overcooking; softening butter.



## Time Features (vary by model)

### Timer Cooking (on some models)

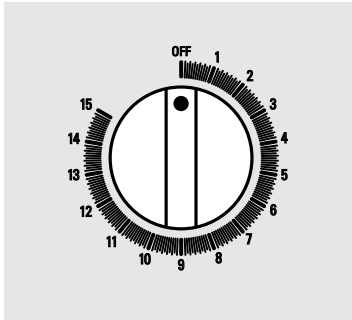

**Turn the dial for up to 15 minutes of cooking time.**

Allows you to microwave for up to 15 minutes.

You may open the door during Timer cooking to check the food. Close the door and cooking resumes automatically.

#### **Popcorn Tip**

For best results when cooking microwave popcorn, turn under the ends of the popcorn bag. This allows the bag to rotate properly in the oven.

### Time Cook (on some models)

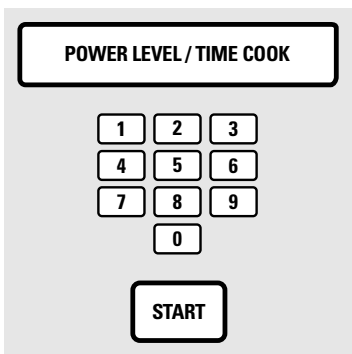

**1 Press POWER LEVEL/TIME COOK one to ten times to choose a power level other than Hi.**

**2 Enter cooking time.**

**3 Press START.**

Allows you to microwave for up to 99 minutes and 99 seconds.

Power Level Hi is automatically set, but you may change it for more flexibility.

You may open the door during Time Cook to check the food. Close the door and press START to resume cooking.

#### **Popcorn Tip**

For best results when cooking microwave popcorn, turn under the ends of the popcorn bag. This allows the bag to rotate properly in the oven.



## Operating Instructions

### Cooking Guide for Timer Cooking and Time Cook

#### Fresh Vegetables

For frozen vegetables, follow the instructions on the package. Place a 10 oz. package in a 1-qt. casserole and add 2–4 tablespoons of water. Turn the dish after half of time.

**NOTE:** Use Power Level Hi unless otherwise noted.

Vegetable	Amount	Time	Comments
Green Beans	1 lb. cut in half	15 to 20 min.	In 1-1/2-qt. casserole, place 1/2 cup water.
Whole Beets	1 bunch	25 to 30 min.	In 2-qt. casserole, place 1/2 cup water.
Broccoli (chopped)	1 bunch (1-1/4 to 1-1/2 lbs.)	10 to 12 min.	In 2-qt. casserole, place 1/2 cup water.
(spears)	1 bunch (1-1/4 to 1-1/2 lbs.)	12 to 15 min.	In 2-qt. casserole, place 1/4 cup water.
Cabbage Wedges		10 to 12 min.	In 2-qt. casserole, place 1/4 cup water.
Sliced Carrots	1 lb.	8 to 10 min.	In 1-1/2-qt. casserole, place 1/4 cup water.
Cauliflower Flowerets	1 medium head	12 to 16 min.	In 2-qt. casserole, place 1/2 cup water.
Corn on the Cob	1 to 5 ears	5 to 6 min. per ear	In 2-qt. casserole, place corn. If corn is in husk, use no water; if corn has been husked, add 1/4 cup water. Rearrange after half of time.
Shelled Peas	2 lbs. unshelled	12 to 14 min.	In 1-qt. casserole, place 1/4 cup water.
Potatoes (cubed, white)	4 potatoes (6 to 8 oz. each)	14 to 16 min.	Peel and cut into 1-inch cubes. Place in 2-qt. casserole with 1/2 cup water. Stir after half of time.
(whole, sweet or white)	1 (6 to 8 oz.)	4 to 6 min.	Pierce with cooking fork. Place in center of the oven. Let stand 5 minutes.
Spinach	10 to 16 oz.	7 to 10 min.	In 2-qt. casserole, place washed spinach.
Squash (summer and yellow)	1 lb. sliced	6 to 8 min.	In 1-1/2-qt. casserole, place 1/4 cup water.
(winter, acorn butternut)	1 to 2 squash (about 1 lb. each)	10 to 13 min.	Cut in half and remove fibrous membranes. In 2-qt. casserole, place squash cut-side-down. Turn cut-side-up after 4 minutes.





## Defrost

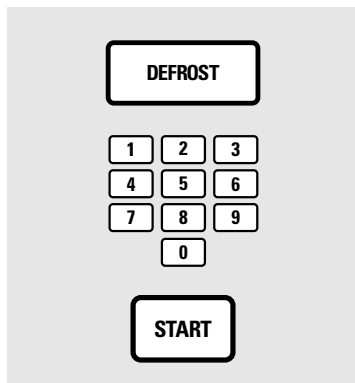

**1 Press DEFROST.**

**2 Enter defrosting time.**

**3 Press START.**

Allows you to defrost for the length of time you select. See the Defrosting Guide for suggested times.

A dull thumping noise may be heard during defrosting. This sound is normal when the oven is not operating at Hi power.

### Defrosting Tips

- Foods frozen in paper or plastic can be defrosted in the package. Tightly closed packages should be slit, pierced or vented **AFTER** food has partially defrosted. Plastic storage containers should be at least partially uncovered.
- Family-size, prepackaged frozen dinners can be defrosted and microwaved. If the food is in a foil container, transfer it to a microwave-safe dish.
- Foods that spoil easily, such as milk, eggs, fish, stuffings, poultry and pork, should not be allowed to sit out for more than one hour after defrosting. Room temperature promotes the growth of harmful bacteria.
- Be sure large meats are completely defrosted before cooking.
- When defrosted, food should be cool but softened in all areas. If still slightly icy, return to the microwave very briefly, or let it stand a few minutes.



# Operating Instructions

## Defrosting Guide

<b>Food</b>	<b>Time</b>	<b>Comments</b>
<b>Breads, Cakes</b> Bread, buns or rolls (1 piece) Sweet Rolls (approx. 12 oz.)	1-1/2 min. 5 to 7 min.	Rearrange after half the time.
<b>Fish and Seafood</b> Fillets, frozen (1 lb.) Shellfish, small pieces (1 lb.)	10 to 13 min. 7 to 9 min.	Place block in casserole. Turn over and break up after half the time.
<b>Fruit</b> Plastic pouch—1 to 2 (10-oz. package)	5 to 8 min.	
<b>Meat</b> Bacon (1 lb.) Franks (1 lb.) Ground meat (1 lb.) Roast: beef, lamb, veal, pork Steaks, chops and cutlets	5 to 7 min. 5 to 7 min. 7 to 9 min. 13 to 17 min. per lb. 7 to 11 min. per lb.	Place unopened package in oven. Let stand 5 minutes after defrosting. Place unopened package in oven. Microwave just until franks can be separated. Let stand 5 minutes, if necessary, to complete defrosting. Turn meat over after half the time. Place unwrapped meat in cooking dish. Turn over after half the time and shield warm areas with foil. Place unwrapped meat in cooking dish. Turn over after half the time and shield warm areas with foil. When finished, separate pieces and let stand to complete defrosting.
<b>Poultry</b> Chicken, broiler-fryer cut up (2-1/2 to 3 lbs.) Chicken, whole (2-1/2 to 3 lbs.) Cornish hen Turkey breast (4 to 5 lbs.)	20 to 24 min. 26 to 30 min. 11 to 17 min. per lb. 7 to 11 min. per lb.	Place wrapped chicken in dish. Unwrap and turn over after half the time. When finished, separate pieces and microwave 2 to 4 minutes more, if necessary. Let stand to finish defrosting. Place wrapped chicken in dish. After half the time, unwrap and turn chicken over. Shield warm areas with foil. Finish defrosting. If necessary, run cold water in the cavity until giblets can be removed. Place unwrapped hen in the oven breast-side-up. Turn over after half the time. Run cool water in the cavity until giblets can be removed. Place unwrapped breast in dish breast-side-down. After half the time, turn over and shield warm areas with foil. Finish defrosting. Let stand 1 to 2 hours in refrigerator to complete defrosting.



# Heating or Reheating Guide

- 1 Directions below are for heating or reheating already-cooked foods stored in refrigerator or at room temperature. Use microwave-safe cookware.
- 2 Cover most foods for fastest, most even heating. Exceptions are some sandwiches, griddle foods and baked items.
- 3 Bubbling around edges of dish is normal, since the center is the last to heat. Foods heated to 160°F. to 165°F. will provide safe, palatable results.

Adjust temperatures to suit your personal taste. Let foods stand a few minutes before serving.

- 4 Be sure foods are heated throughout before serving. Steaming or bubbling around edges of dish does not necessarily mean food is heated throughout.

***If you use a meat thermometer while cooking, make sure it is safe for use in microwave ovens.***

**NOTE: Use Power Level Hi unless otherwise noted.**

<b>Food</b>	<b>Amount</b>	<b>Power Level</b>	<b>Time</b>
<b>Bakery Foods</b>			
Cake, coffee cake, doughnuts, sweet rolls, nut or fruit bread	1 piece 9 inch cake or 12 rolls or doughnuts	Low (30) Low (30)	1/2 to 2 min. 3 to 5 min.
Dinner rolls, muffins	1 6 to 8	Medium (50) Medium (50)	1/2 to 1 min. 1-1/2 to 2-1/2 min.
Pie	1 slice 9 inch pie	Med-High (70)	1 to 1-1/2 min. 6 to 8 min.
<b>Beverages</b>			
Cocoa, other milk-based drinks (6 oz. cup)	1 to 2 cups	Med-High (70)	4 to 7 min.
Coffee, other water-based drinks (6 oz. cup)	1 to 2 cups		2 to 4 min.
<b>Meats and Main Dishes</b>			
Chicken pieces, hamburger, meat pieces	1 to 2 pieces		3 to 5 min.
Hot dogs and sausages	1 to 2		1 to 2 min.
Rice and pasta (2/3–3/4 cup per serving)	1 to 2 servings		1-1/2 to 4 min.
Saucy, main dishes: chop suey, spaghetti, creamed chicken, chili, stew, macaroni and cheese, etc. (3/4–1 cup per serving)	1 to 2 servings		4 to 6 min.
<b>Plate of Leftovers</b>	1 plate		4 to 6 min.
<b>Sandwiches</b>	1 to 2 servings	Med-High (70)	2 to 4 min.
<b>Soups</b> (6 oz. serving)	1 to 2 servings	Med-High (70)	2 to 4 min.
<b>Vegetables</b>	1 to 2 servings		2 to 3 min.



## Operating Instructions

### *Other Features Your Model May Have*

#### **Cooking Complete Reminder**

To remind you that you have food in the oven, the oven will beep once a minute until you either open the oven door or press CLEAR/OFF.

#### **Clock**

CLOCK

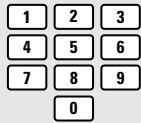

Press to enter the time of day or to check the time of day while microwaving.

- 1** Press CLOCK.
- 2** Enter time of day.
- 3** Press CLOCK.

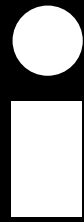

### *Microwave Terms*

#### **Microwave Terms**

<b>Term</b>	<b>Definition</b>
<b>Arcing</b>	Arcing is the microwave term for sparks in the oven. Arcing is caused by: <ul style="list-style-type: none"><li>• metal or foil touching the side of the oven.</li><li>• foil that is not molded to food (upturned edges act like antennas).</li><li>• metal such as twist ties, poultry pins, gold-rimmed dishes.</li><li>• recycled paper towels containing small metal pieces.</li></ul>
<b>Covering</b>	Covers hold in moisture, allow for more even heating and reduce cooking time. Venting plastic wrap or covering with wax paper allows excess steam to escape.
<b>Shielding</b>	In a regular oven, you shield chicken breasts or baked foods to prevent over-browning. When microwaving, you use small strips of foil to shield thin parts, such as the tips of wings and legs on poultry, which would cook before larger parts.
<b>Standing Time</b>	When you cook with regular ovens, foods such as roasts or cakes are allowed to stand to finish cooking or to set. Standing time is especially important in microwave cooking. Note that a microwaved cake is not placed on a cooling rack.
<b>Venting</b>	After covering a dish with plastic wrap, you vent the plastic wrap by turning back one corner so excess steam can escape.



## Helpful Information

### Care and Cleaning

#### Helpful Hints



Opening the oven door a few minutes after cooking helps air out the inside. An occasional thorough wiping with a solution of baking soda and water keeps the inside fresh.

**UNPLUG THE CORD BEFORE CLEANING ANY PART OF THIS OVEN.**

#### How to Clean the Inside

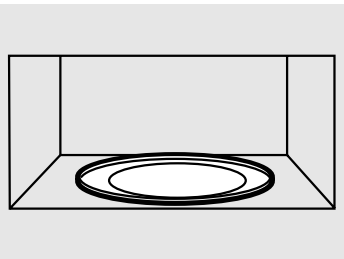

**Walls, Floor, Inside Window, Metal and Plastic Parts on the Door.** Some spatters can be removed with a paper towel, others may require a damp cloth. Remove greasy spatters with a sudsy cloth, then rinse with a damp cloth. Do not use abrasive cleaners or sharp utensils on oven walls. **Never use a commercial oven cleaner on any part of your microwave.**

**Removable Turntable and Turntable Support.** To prevent breakage, do not place the turntable into water just after cooking. Wash it carefully in warm, sudsy water or in the dishwasher. The turntable and support can be broken if dropped. Remember, do not operate the oven without the turntable and support in place.

## How to Clean the Outside

**Do not use cleaners containing ammonia or alcohol on the microwave oven. Ammonia or alcohol can damage the appearance of the microwave.**

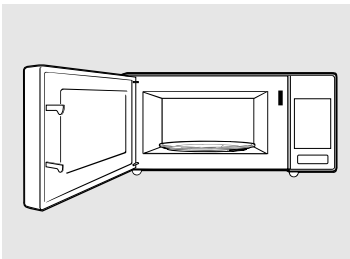

**Case.** Clean the outside of the microwave with a sudsy cloth. Rinse and then dry. Wipe the window clean with a damp cloth.

**Control Panel and Door.** Wipe with a damp cloth. Dry thoroughly. Do not use cleaning sprays, large amounts of soap and water, abrasives or sharp objects on the panel—they can damage it. Some paper towels can also scratch the control panel.

**Door Surface.** It's important to keep the area clean where the door seals against the microwave. Use only mild, non-abrasive detergents applied with a clean sponge or soft cloth. Rinse well.



## ***If Something Goes Wrong***

### *Before You Call for Service*

<b><i>Problem</i></b>	<b><i>Possible Causes</i></b>	<b><i>What to Do</i></b>
<b><i>Oven Will Not Come On</i></b>	A fuse in your home may be blown or the circuit breaker tripped.	<ul style="list-style-type: none"><li>• Replace fuse or reset circuit breaker.</li></ul>
	Power surge.	<ul style="list-style-type: none"><li>• Unplug the microwave oven, then plug it back in.</li></ul>
	Plug not fully inserted into wall outlet.	<ul style="list-style-type: none"><li>• Make sure the 3-prong plug on the oven is fully inserted into wall outlet.</li></ul>
	Door not securely closed.	<ul style="list-style-type: none"><li>• Open the door and close securely.</li></ul>
<b><i>Foods Are Either Overcooked or Undercooked</i></b>	Cooking times may vary because of starting food temperature, food density or amount of foods in oven.	<ul style="list-style-type: none"><li>• Set additional cooking time for completion.</li></ul>
	Food was not rearranged or stirred.	<ul style="list-style-type: none"><li>• Some dishes require specific instructions. Check Cooking Guide or recipe for instructions.</li></ul>
<b><i>Control Panel Lighted, Yet Oven Will Not Start</i></b>	Door not securely closed.	<ul style="list-style-type: none"><li>• Open the door and close securely.</li></ul>
	START pad not pressed after entering cooking selection.	<ul style="list-style-type: none"><li>• Press START.</li></ul>
	Another selection entered already in oven and CLEAR/OFF pad not pressed to cancel it.	<ul style="list-style-type: none"><li>• Press CLEAR/OFF.</li></ul>
	Cooking time not entered after pressing POWER LEVEL/TIME COOK.	<ul style="list-style-type: none"><li>• Make sure you have entered cooking time after pressing POWER LEVEL/TIME COOK.</li></ul>
	CLEAR/OFF was pressed accidentally.	<ul style="list-style-type: none"><li>• Reset cooking program and press START.</li></ul>



---

## *All These Things are Normal with Your Microwave Oven*



- Steam or vapor escaping from around the door.
- Light reflection around door or outer case.
- Dimming oven light and change in blower sound may occur while operating at power levels other than high.
- Dull thumping sound while oven is operating.
- Some TV-radio interference might be noticed while using your microwave oven. It's similar to the interference caused by other small appliances and does not indicate a problem with your microwave. If you notice this interference, check that the microwave oven is on a different electrical circuit, relocate the radio or TV as far away from the microwave as possible, or check the position and signal of the receiving antenna.

## **GE Service Numbers**



*We'll be there!*

### **GE Answer Center®**

**800.626.2000**

Whatever your question about any GE major appliance, GE Answer Center® information service is available to help. Your call—and your question—will be answered promptly and courteously.

And you can call any time. GE Answer Center® service is open 24 hours a day, 7 days a week.

### **In-Home Repair Service**

**800-GE-CARES  
(800-432-2737)**

A GE consumer service professional will provide expert repair service, scheduled at a time that's convenient for you. Many GE Consumer Service company-operated locations offer you service today or tomorrow, or at your convenience (7:00 a.m. to 7:00 p.m. weekdays, 9:00 a.m. to 2:00 p.m. Saturdays).

Our factory-trained technicians know your appliance inside and out—so most repairs can be handled in just one visit.

### **For Customers With Special Needs**

**800.626.2000**

Upon request, GE will provide Braille controls for a variety of GE appliances, and a brochure to assist in planning a barrier-free kitchen for persons with limited mobility. To obtain these items, free of charge, call 800.626.2000.

Consumers with impaired hearing or speech who have access to a TDD or a conventional teletypewriter may call 800-TDD-GEAC (800-833-4322) to request information or service.



**Para los clientes  
de habla española**

**800.626.2000**

Para obtener instrucciones en español, llame a GE Answer Center<sup>®</sup>, servicio de información para el consumidor, teléfono 800.626.2000.

**Service Contracts**

**800-626-2224**

You can have the secure feeling that GE Consumer Service will still be there after your warranty expires.

Purchase a GE contract while your warranty is still in effect and you'll receive a substantial discount. With a multiple-year contract, you're assured of future service at today's prices.

**Parts and Accessories**

**800-626-2002**

Individuals qualified to service their own appliances can have parts or accessories sent directly to their home. The GE parts system provides access to over 47,000 parts...and all GE Genuine Renewal Parts are fully warranted. VISA, MasterCard and Discover cards are accepted.

**Care and cleaning instructions contained in this manual cover procedures to be performed by any user. Other servicing generally should be referred to qualified service personnel. Caution must be exercised, since improper servicing may cause unsafe operation.**

**Further Service**

We're proud of our service and want you to be pleased. If for some reason you are not happy with the service you receive, here are steps to follow for further help.

**First**, contact the people who serviced your appliance. Explain why you are not pleased. In most cases, this will solve the problem.

**Next**, if you are still not pleased, write all the details—including your phone number—to:  
Manager, Consumer Relations  
GE Appliances, Appliance Park  
Louisville, KY 40225

# MICROWAVE OVEN WARRANTY

*Staple sales slip or cancelled check here. Proof of original purchase date is needed to obtain service under warranty.*

## What is Covered

### LIMITED ONE-YEAR WARRANTY

For one year from date of original purchase, we will provide, free of charge, parts and service labor to repair or replace *any part of the microwave oven* that fails because of a manufacturing defect.

### LIMITED ADDITIONAL FOUR-YEAR WARRANTY

For the second through the fifth year from the date of original purchase, we will provide, free of charge, a replacement *magnetron tube* if the magnetron tube fails because of a manufacturing defect. You pay for the service trip to your home and service labor charges.

#### For each of the above warranties:

To avoid any trip charges, you must take the microwave oven to a General Electric Factory Service Center or a General Electric Customer Care® servicer and pick it up following service.

In-home service is also available, but you must pay for the service technician's travel costs to your home.

\*\*\*\*\*

This warranty is extended to the original purchaser and any succeeding owner for products purchased for ordinary home use in the 48 mainland states, Hawaii and Washington, D.C. In Alaska the warranty is the same except that it is LIMITED because you must pay to ship the product to the service shop or for the service technician's travel costs to your home.

All warranty service will be provided by our Factory Service Centers or by our authorized Customer Care® servicers during normal working hours.

Should your appliance need service, during warranty period or beyond, call 800-GE-CARES (800-432-2737).

## What is Not Covered

- Service trips to your home to teach you how to use the product.

**Read your Owner's Manual.** If you then have any questions about operating the product, please contact your dealer or our Consumer Affairs office at the address below, or call, toll free:

GE Answer Center®  
**800.626.2000**  
consumer information service

- Improper installation.

If you have an installation problem, contact your dealer or installer. You are responsible for providing adequate electrical, exhausting and other connecting facilities.

- Replacement of house fuses or resetting of circuit breakers.
- Failure of the product if it is misused, or used for other than the intended purpose or used commercially.
- Damage to product caused by accident, fire, floods or acts of God.

WARRANTOR IS NOT RESPONSIBLE FOR CONSEQUENTIAL DAMAGES.

Some states do not allow the exclusion or limitation of incidental or consequential damages, so the above limitation or exclusion may not apply to you. This warranty gives you specific legal rights, and you may also have other rights which vary from state to state. To know what your legal rights are in your state, consult your local or state consumer affairs office or your state's Attorney General.

**Warrantor: General Electric Company** If further help is needed concerning this warranty, write:  
**Manager—Consumer Affairs, GE Appliances, Louisville, KY 40225**

Part No. 164D3333P003  
Pub. No. 49-8739

9-99 CG

Printed in Malaysia

JE510

JE520